

## °C-Lite /°C-Lite Klima

Digital room thermostat for surface heating and cooling systems with built-in multi-sensor and digital communication via 1-Wire bus in conjunction with a current version of the °CALEONbox - see "Compatibility and connection °C-Lite with °CALEONbox" on page 2. Intuitive operation via integrated touch areas and LEDs. Monitoring of air quality (°C-Lite Klima) possible via coloured status LED.

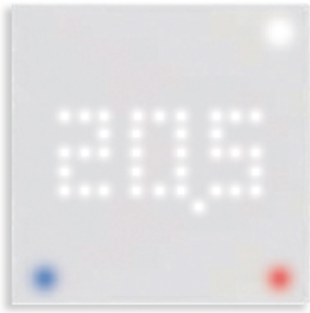

### Technical Data

<b>Power Supply</b>	5V DC ( +/- 10 %)	<b>Protection Class</b>	IP20
<b>power consumption</b>	0,6 W	<b>Dimension</b>	55 mm x 55 mm
<b>Measurement Range</b>		<b>Housing</b>	Plastic Pure white
Temperature:	0 °C ... 60 °C	<b>Mounting</b>	Surface / flush-mounted
- Accuracy / resolution:	+/- 1°C / 0,1 °C		
<b>Humidity*:</b>	0% ... 100%		
- Accuracy / resolution:	(+/- 6 % / 0,1 %)		
<b>CO2 equivalent**:</b>	0 ppm - 9999 ppm		
<b>Air quality IAQ**:</b>	0 - 999		

\* only in °C-Lite Klima version, \*\* as a guideline, only in °C-Lite Klima version

## Wall mounting and electrical connection

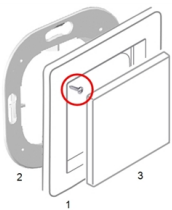

Mount the sensor in a suitable location.



### Caution!

Device and function may be damaged. Select a suitable environmental condition. Direct sunlight, sources of heat and cold, e.g. radiators and windows must be avoided.

### Mounting in plastic wall socket

Attach the mounting frame (2) to the switch box. Make the electrical connection as described below.

### Electrical connection

Connect the sensor to 5V DC power supply. GND = Grey DQ= Orange, VCC= Red

### Insert the Element

Screw the cover frame (1 - not included in the scope of delivery) to the mounting ring (2) using the two screws supplied (2.2 x 4.5 mm) diagonally at the top left and bottom right. Align the °C-Lite (3) with the mounting frame and press it in until it engages in the frame.



## 1-Wire ID

Each sensor has a unique 1-Wire ID. This ID is required for sensor room assignment in the °CALEONbox. You will find the ID on the small sticker supplied.

1-Wire ID:  
E0-D5-5E-0E-69-F1

## LED

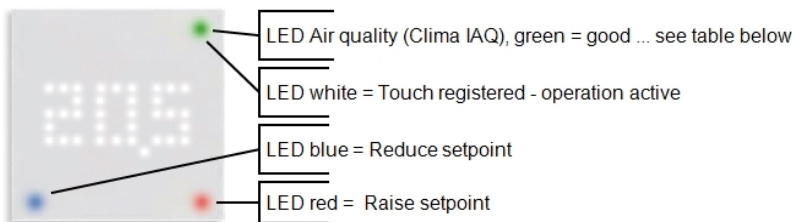

## Measured values IAQ and CO2 equivalent

In the first few days after installation, the °C-Lite Klima goes through a calibration phase during which fluctuating measurements and major deviations may occur.

CO2	Air quality	IAQ	Air quality*
< 800 ppm	Excellent	0 - 100	Good
800 - 1000 ppm	Good	101 - 150	Moderate
1000 - 1400 ppm	Satisfactory	151 - 200	Unhealthy for sensitive groups of people
1400 - 2000 ppm	Medium (ventilation recommended)	201 - 250	Unhealthy
2000 - 3000 ppm	Bad (ventilation required)	251 - 300	Very unhealthy
> 3000 ppm	Very bad (ventilation required)	301+ [LED flashes high-frequency]	Hazardous to health

\* The faster the LED flashes, the poorer the air quality

# Operation

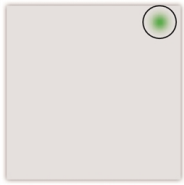

## Standby Screen

IAQ ok (°C-Lite Clima) Touching the touch areas activates "Display".

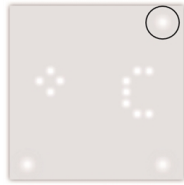

## Measuring unit and measured value display

The first touch of the touch area shows the temperature. Repeated touching changes to other measured values and first shows the unit and after a short time the measured value.

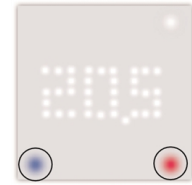

## Setpoint adjustment

The set temperature can be reduced or increased by touching the blue and red touch areas.

# °C-Lite room assignment

There are two ways to assign °C-Lite to a room:

- using the unit ID via the °CALEON menu 'Expert -> Settings -> Rooms -> Room X -> Temperature / Humidity'.
- as described under 1. via the °CALEON menu in combination with the Touch-To-Assign function (T2A) on the °C-Lite.

**Expert > Settings > Rooms**

**Select or add room**

**Select sensor type**  
Temperature / Humidity

**Assign sensor**

**Assignment successful**

Touch °C-Lite on one of the three touch areas to assign it to the selected room.

LED lights up blue while the connection is being established.

LED lights up green if the assignment was successful.

Assignment successful

When opening the sensor list, °C-Lite automatically switches to Touch-To-Assign mode

# Set room setpoint

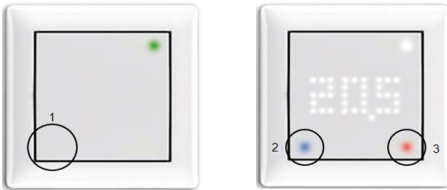

- Activate the room setpoint menu (1) by touching the touch area (1). Reduce (2) or raise (3) the room setpoint by touching the touch areas.

After 20 seconds, the display returns to the standby screen.

The set room setpoint is valid until the next change via °CALEON timer or manually.

# Compatibility and connection °C-Lite with °CALEONbox

The following must be observed when connecting °C-Lite with the °CALEONbox:

- Art. No. until .....n**  
no °C-Lite via 5V DC, external power supply and software update required
- Art. No. from .....o**  
1 °C-Lite via 5V DC, external power supply unit and software update required for others
- Art. No. from .....p**  
up to 8 °C-Lite can be connected

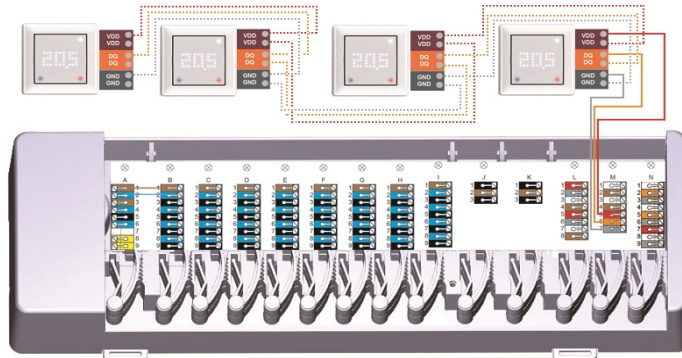

The 1-Wire system must be realised with 3 wires (5VDC, DQ, GND). The total cable length can be up to 100m. Use a suitable twisted pair cable and ensure sufficient wire cross-section, e.g. with LIYCY 2 x 2 x 0.75mm<sup>2</sup>, to avoid impermissible voltage drop at the °C-Lite below  $U_{min} = 4.5VDC$ .

